

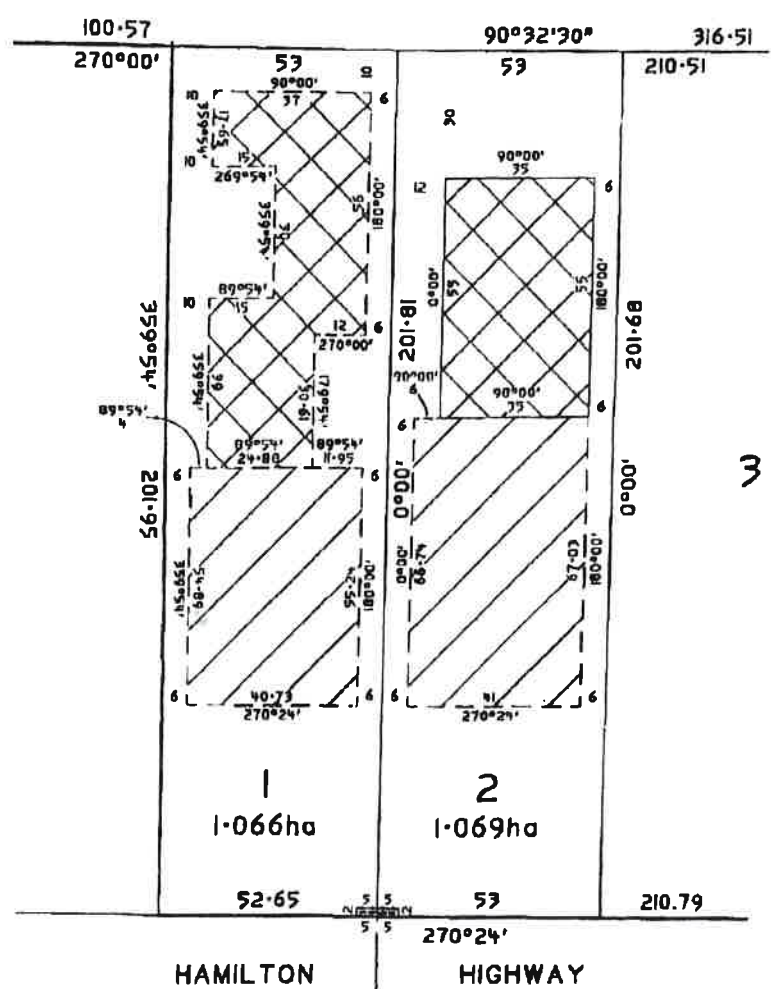



4



HAMILTON HIGHWAY  
 ACCESS TO LOTS 1 AND 2 IS TO BE VIA THEIR INDIVIDUAL ACCESS ENVELOPES TO A MERGED DRIVEWAY IN THE ROAD RESERVE WITH A SINGLE ENTRY POINT ONTO THE CARRIAGEWAY

-  PROPOSED BUILDING AND EFFLUENT ENVELOPES SHOWN CROSS HATCHED.
-  PROPOSED EFFLUENT ENVELOPES SHOWN HATCHED.
-  PROPOSED ACCESS ENVELOPES SHOWN THUS.

DIMENSIONS AND AREAS SHOWN HEREON ARE SUBJECT TO SURVEY.

**BRAYLEY & HAYES**  
 LAND & ENGINEERING SURVEYORS  
 85 KENNEDY STREET, HAMILTON, 3300  
 PHONE: (03) 5571 9171  
 EMAIL: admin@brayleyandhayes.com.au

**PROPOSED SUBDIVISION**

**RICK AND JANENE O'CONNELL**  
 8010 HAMILTON HIGHWAY, TARRINGTON  
 PARISH OF HAMILTON SOUTH  
 SECTION 11  
 PART OF CROWN ALLOTMENT 4

DATE	13/11/17
TITLE	0787/289
DESIGNED	MGD
VERSION	2
REF	17034 PP

ORIGINAL SHEET SIZE	A3	ENLARGEMENT SCALE	1:1000
---------------------	----	-------------------	--------

SHEET 2 OF 2

This document was printed from SPP/EAR on: 02/02/2018 02:29 pm.